

Intended for
Mr. Adam Parisi
Assistant Superintendent for Finance and Operations
Mount Prospect School District 57
701 West Gregory
Mt. Prospect, IL 60056

Date
May 2017

Project Number
21 42941A

Mount Prospect School District 57
701 West Gregory
Mt. Prospect, Illinois 60056
DRINKING WATER TESTING AT
LIONS PARK ELEMENTARY SCHOOL



**Mount Prospect School District 57
Lions Park Elementary School**

CONTENTS

1.	INTRODUCTION	1
2.	RESULTS	1
3.	CONCLUSIONS	2

APPENDICES

Appendix A	Laboratory Reports
Appendix B	Floor Plans

ACRONYMS AND ABBREVIATIONS

AL	Action Level
EMT	Environmental Monitoring Technologies
IDPH	Illinois Department of Public Health
IL ELAP	Illinois Environmental Laboratory Accreditation Program
ml	milliliter
ppb	parts per billion
Ramboll Environ	Ramboll Environ US Corporation
NELAP	National Environmental Laboratory Accreditation Program
SD 57	Mount Prospect School District 57
RL	Reporting Limit
Unit Conversion	1 ppb = 0.001 mg/L (15 ppb = 0.015 mg/L)
USEPA	United States Environmental Protection Agency

1. INTRODUCTION

The following report summarizes the findings of the lead in drinking water testing conducted for the Mount Prospect School District (SD 57) at Lions Park Elementary School.

A total of one-hundred five (105) water samples were collected from Lions Park Elementary School. Sampling locations included all fountains, sinks used for food preparation and sinks present in rooms occupied by students of kindergarten age or lower or that maybe used by these students in the future. These locations were identified on building floor plans by SD 57.

Samples were collected on April 14, 2017 in new, sealed 250 milliliter (ml) bottles after the water was stagnant in the building piping for a minimum of 8 hours, but not more than 18 hours. All samples were collected from the fixtures as "first draw" and "flush". The flush sample was collected approximately 30 seconds following the first draw sample. In the case of multiple faucets draining to the same drain, only one flush sample is required to be collected. Each sample bottle was labeled with a unique sampling number specific for each individual fixture tested. Samples listed with a 'P' are first draw and samples listed with an 'F' are flush samples. Samples were submitted using chain-of-custody forms provided by the laboratory.

Samples were analyzed by Environmental Monitoring Technologies (EMT) located in Morton Grove, IL, using Lab Method 200.8. This method has a Reporting Limit (RL) of 2 parts per billion (ppb) for lead. EMT participates in the Illinois Environmental Laboratory Accreditation Program (IL ELAP) and National Environmental Laboratory Accreditation Program (NELAP) accreditation number 100256, certificate number 003674.

Laboratory reports are included in Appendix A. School building floor plans noting the sample locations are included in Appendix B.

Samples were collected by Mr. Chien-Ju Wu and Mr. Kit Carson, Associates with Ramboll Environ US Corporation (Ramboll Environ). Project management was performed by Mr. Robert Livingston, RS, LEHP Manager with Ramboll Environ. Project oversight was provided by Mr. Robert Rottersman, MS, CIH Principal with Ramboll Environ.

2. RESULTS

A total of one-hundred five (105) water samples were collected from Lions Park Elementary School. Eight (8) of the samples were found to have lead concentrations greater than the Illinois Department of Public Health (IDPH) reporting limit of 5 ppb – but less than United States Environmental Protection Agency's (USEPA) Action Level (AL) of 15 ppb. Four (4) samples had a lead level above the USEPA AL. Ninety-seven (97) samples had lead levels less than 5 ppb.

Sample results for samples above 5 ppb and below 15 ppb are listed below:

- Room 110, sink – first draw 10.5 ppb/flush <2.0 ppb
- Room 115, sink – first draw 5.60 ppb
- Room 122, drinking fountain – first draw – 5.83 ppb/flush 4.28 ppb
- Room 122, sink – first draw – 6.04 ppb

Sample results greater than 15 ppb are listed below:

- Room 137, sink – first draw 17.2 ppb
- Room 130, sink – first draw 32.6 ppb
- Room 120, drinking fountain – first draw 20.5 ppb/flush 2.83
- Room 120, sink – first draw 22.6 ppb

3. CONCLUSIONS

One-hundred five (105) water samples were collected at Lions Park Elementary School on April 14, 2017. Ninety-seven (97) of the samples were below the current IDPH requirement of 5 ppb lead.

Based on the results of the sampling and in accordance with the new IDPH requirements, SD 57 is required to:

1. Notify all parents and guardians in writing or electronically about the test results which are greater than (>) 5 ppb,
2. Provide information about lead in drinking water that can be found on the USEPA website (<http://www.epa.gov/ground-water-and-drinking-water/basic-information-about-lead-in-drinking-water>),
3. Post any sample results reported to be less than (<) 5 ppb on the School Districts website at a minimum,
4. SD 57 must submit these sample results by emailing this report to the IDPH at the following address: dph.leadh2o@illinois.gov. IDPH requires results be submitted within 7 days.

If you have any questions regarding this report, please do not hesitate to contact us.

Sincerely,

Ramboll Environ US Corporation



Robert M. Livingston, RS, LEHP
Manager
D 312.288.3844
rlivington@ramboll.com

Reviewed by,



Robert B. Rottersman, MS, CIH
Principal
D 312.288.3857
rrottersman@ramboll.com

**Mount Prospect School District 57
Lions Park Elementary School**

**APPENDIX A
LABORATORY REPORTS**

Analytical Report

Bob Livingston
Ramboll Environ
333 West Wacker Drive, Suite 2700
Chicago, IL 60606

April 21, 2017

Work Order: 17D0650

RE: Drinking Water Analysis
21-42941A Lions Park

Dear Bob Livingston:

Enclosed are the analytical reports for the EMT Work Order listed. Also included with this analytical report is a copy of the chain of custody associated with these samples. If you have any questions, please contact me.

Sincerely,

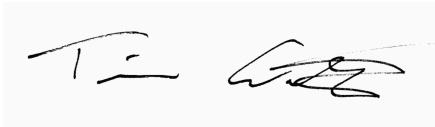

Tim Witrzek
Project Manager
847.967.6666

Approved by,



Matthew Gregory
Technical Manager

Approved for release: 4/21/2017 11:50:40AM

The contents of this report apply to the sample(s) analyzed. No duplication is allowed except in its entirety.
Reporting limits are adjusted for sample size used, dilutions and moisture content, if applicable.

State of Illinois, NELAP Accredited Lab No. 100256, Cert No. 003674



Table of Contents

Cover Letter	1
Case Narrative	3
Client Sample Results	6
Qualifiers and Definitions	23
Certified Analyses	23
List of Certifications	24
Chain of Custody	25

Case Narrative

Client: Ramboll Environ
Project: Drinking Water Analysis
 21-42941A Lions Park
Work Order: 17D0650

Date: 04/21/2017

All reported results are within defined laboratory quality control objectives unless listed below or otherwise qualified in this report.

Sample Summary

Sample ID	Laboratory ID	Matrix	Date Sampled	Last Time Used:	Date Received
177-SK-P	17D0650-01	Drinking Water	04/14/17 10:26	04/13/17 22:00	04/14/17 16:45
177-SK-F	17D0650-02	Drinking Water	04/14/17 10:26	04/13/17 22:00	04/14/17 16:45
179-SK-P	17D0650-03	Drinking Water	04/14/17 10:30	04/13/17 22:00	04/14/17 16:45
179-SK-F	17D0650-04	Drinking Water	04/14/17 10:30	04/13/17 22:00	04/14/17 16:45
180-SK-P	17D0650-05	Drinking Water	04/14/17 10:38	04/13/17 22:00	04/14/17 16:45
180-SK-F	17D0650-06	Drinking Water	04/14/17 10:38	04/13/17 22:00	04/14/17 16:45
110-SK1-P	17D0650-07	Drinking Water	04/14/17 10:43	04/13/17 22:00	04/14/17 16:45
110-SK1-F	17D0650-08	Drinking Water	04/14/17 10:43	04/13/17 22:00	04/14/17 16:45
110-SK2-P	17D0650-09	Drinking Water	04/14/17 10:44	04/13/17 22:00	04/14/17 16:45
102-SK-P	17D0650-10	Drinking Water	04/14/17 10:48	04/13/17 22:00	04/14/17 16:45
102-SK-F	17D0650-11	Drinking Water	04/14/17 10:48	04/13/17 22:00	04/14/17 16:45
111-SK1-P	17D0650-12	Drinking Water	04/14/17 10:51	04/13/17 22:00	04/14/17 16:45
111-SK1-F	17D0650-13	Drinking Water	04/14/17 10:51	04/13/17 22:00	04/14/17 16:45
111-SK2-P	17D0650-14	Drinking Water	04/14/17 10:52	04/13/17 22:00	04/14/17 16:45
137-SK1-P	17D0650-15	Drinking Water	04/14/17 10:59	04/13/17 22:00	04/14/17 16:45
137-SK1-F	17D0650-16	Drinking Water	04/14/17 10:59	04/13/17 22:00	04/14/17 16:45
137-SK2-P	17D0650-17	Drinking Water	04/14/17 11:00	04/13/17 22:00	04/14/17 16:45
130-DF-P	17D0650-18	Drinking Water	04/14/17 11:02	04/13/17 22:00	04/14/17 16:45
130-DF-F	17D0650-19	Drinking Water	04/14/17 11:02	04/13/17 22:00	04/14/17 16:45
130-SK-P	17D0650-20	Drinking Water	04/14/17 11:03	04/13/17 22:00	04/14/17 16:45
113-DF-P	17D0650-21	Drinking Water	04/14/17 11:05	04/13/17 22:00	04/14/17 16:45
113-DF-F	17D0650-22	Drinking Water	04/14/17 11:05	04/13/17 22:00	04/14/17 16:45
113-SK-P	17D0650-23	Drinking Water	04/14/17 11:06	04/13/17 22:00	04/14/17 16:45
129-DF-P	17D0650-24	Drinking Water	04/14/17 11:09	04/13/17 22:00	04/14/17 16:45
129-DF-F	17D0650-25	Drinking Water	04/14/17 11:09	04/13/17 22:00	04/14/17 16:45
129-SK-P	17D0650-26	Drinking Water	04/14/17 11:10	04/13/17 22:00	04/14/17 16:45
114-DF-P	17D0650-27	Drinking Water	04/14/17 11:13	04/13/17 22:00	04/14/17 16:45
114-DF-F	17D0650-28	Drinking Water	04/14/17 11:13	04/13/17 22:00	04/14/17 16:45
114-SK-P	17D0650-29	Drinking Water	04/14/17 11:14	04/13/17 22:00	04/14/17 16:45
115-DF-P	17D0650-30	Drinking Water	04/14/17 11:19	04/13/17 22:00	04/14/17 16:45
115-DF-F	17D0650-31	Drinking Water	04/14/17 11:19	04/13/17 22:00	04/14/17 16:45
115-SK-P	17D0650-32	Drinking Water	04/14/17 11:20	04/13/17 22:00	04/14/17 16:45
128-SK1-P	17D0650-33	Drinking Water	04/14/17 11:23	04/13/17 22:00	04/14/17 16:45
128-SK1-F	17D0650-34	Drinking Water	04/14/17 11:23	04/13/17 22:00	04/14/17 16:45
128-SK2-P	17D0650-35	Drinking Water	04/14/17 11:24	04/13/17 22:00	04/14/17 16:45

8100 N. Austin Avenue Morton Grove, IL 60053-3203 P 847.967.6666 800.246.0663 F 847.967.6735 www.emt.com

128-SK3-P	17D0650-36	Drinking Water	04/14/17 11:24	04/13/17 22:00	04/14/17 16:45
128-SK4-P	17D0650-37	Drinking Water	04/14/17 11:24	04/13/17 22:00	04/14/17 16:45
116-DF-P	17D0650-38	Drinking Water	04/14/17 11:30	04/13/17 22:00	04/14/17 16:45
116-DF-F	17D0650-39	Drinking Water	04/14/17 11:30	04/13/17 22:00	04/14/17 16:45
116-SK-P	17D0650-40	Drinking Water	04/14/17 11:31	04/13/17 22:00	04/14/17 16:45
BRG1-WC-P	17D0650-41	Drinking Water	04/14/17 11:33	04/13/17 22:00	04/14/17 16:45
BRG1-WC-F	17D0650-42	Drinking Water	04/14/17 11:33	04/13/17 22:00	04/14/17 16:45
BRB1-WC-P	17D0650-43	Drinking Water	04/14/17 11:34	04/13/17 22:00	04/14/17 16:45
BRB1-WC-F	17D0650-44	Drinking Water	04/14/17 11:34	04/13/17 22:00	04/14/17 16:45
117-DF-P	17D0650-45	Drinking Water	04/14/17 11:37	04/13/17 22:00	04/14/17 16:45
117-DF-F	17D0650-46	Drinking Water	04/14/17 11:37	04/13/17 22:00	04/14/17 16:45
117-SK-P	17D0650-47	Drinking Water	04/14/17 11:38	04/13/17 22:00	04/14/17 16:45
118-SK-P	17D0650-48	Drinking Water	04/14/17 11:41	04/13/17 22:00	04/14/17 16:45
118-SK-F	17D0650-49	Drinking Water	04/14/17 11:41	04/13/17 22:00	04/14/17 16:45
119-DF-P	17D0650-50	Drinking Water	04/14/17 11:46	04/13/17 22:00	04/14/17 16:45
119-DF-F	17D0650-51	Drinking Water	04/14/17 11:46	04/13/17 22:00	04/14/17 16:45
119-SK-P	17D0650-52	Drinking Water	04/14/17 11:47	04/13/17 22:00	04/14/17 16:45
120-DF-P	17D0650-53	Drinking Water	04/14/17 11:49	04/13/17 22:00	04/14/17 16:45
120-DF-F	17D0650-54	Drinking Water	04/14/17 11:49	04/13/17 22:00	04/14/17 16:45
120-SK-P	17D0650-55	Drinking Water	04/14/17 11:50	04/13/17 22:00	04/14/17 16:45
124-DF-P	17D0650-56	Drinking Water	04/14/17 11:53	04/13/17 22:00	04/14/17 16:45
124-DF-F	17D0650-57	Drinking Water	04/14/17 11:53	04/13/17 22:00	04/14/17 16:45
124-SK-P	17D0650-58	Drinking Water	04/14/17 11:54	04/13/17 22:00	04/14/17 16:45
123-DF-P	17D0650-59	Drinking Water	04/14/17 11:56	04/13/17 22:00	04/14/17 16:45
123-DF-F	17D0650-60	Drinking Water	04/14/17 11:56	04/13/17 22:00	04/14/17 16:45
123-SK-P	17D0650-61	Drinking Water	04/14/17 11:57	04/13/17 22:00	04/14/17 16:45
121-DF-P	17D0650-62	Drinking Water	04/14/17 12:00	04/13/17 22:00	04/14/17 16:45
121-DF-F	17D0650-63	Drinking Water	04/14/17 12:00	04/13/17 22:00	04/14/17 16:45
121-SK-P	17D0650-64	Drinking Water	04/14/17 12:01	04/13/17 22:00	04/14/17 16:45
122-DF-P	17D0650-65	Drinking Water	04/14/17 12:04	04/13/17 22:00	04/14/17 16:45
122-DF-F	17D0650-66	Drinking Water	04/14/17 12:04	04/13/17 22:00	04/14/17 16:45
122-SK-P	17D0650-67	Drinking Water	04/14/17 12:05	04/13/17 22:00	04/14/17 16:45
BRB2-WC-P	17D0650-68	Drinking Water	04/14/17 12:07	04/13/17 22:00	04/14/17 16:45
BRB2-WC-F	17D0650-69	Drinking Water	04/14/17 12:07	04/13/17 22:00	04/14/17 16:45
BRG2-WC-P	17D0650-70	Drinking Water	04/14/17 12:08	04/13/17 22:00	04/14/17 16:45
BRG2-WC-F	17D0650-71	Drinking Water	04/14/17 12:08	04/13/17 22:00	04/14/17 16:45
164-WC1-P	17D0650-72	Drinking Water	04/14/17 12:14	04/13/17 22:00	04/14/17 16:45
164-WC1-F	17D0650-73	Drinking Water	04/14/17 12:14	04/13/17 22:00	04/14/17 16:45
164-WC2-P	17D0650-74	Drinking Water	04/14/17 12:13	04/13/17 22:00	04/14/17 16:45
164-WC2-F	17D0650-75	Drinking Water	04/14/17 12:13	04/13/17 22:00	04/14/17 16:45
159-SK1-P	17D0650-76	Drinking Water	04/14/17 12:20	04/13/17 22:00	04/14/17 16:45
159-SK1-F	17D0650-77	Drinking Water	04/14/17 12:20	04/13/17 22:00	04/14/17 16:45
159-SK2-P	17D0650-78	Drinking Water	04/14/17 12:21	04/13/17 22:00	04/14/17 16:45
BRB3-WC-P	17D0650-79	Drinking Water	04/14/17 12:25	04/13/17 22:00	04/14/17 16:45
BRB3-WC-F	17D0650-80	Drinking Water	04/14/17 12:25	04/13/17 22:00	04/14/17 16:45
BRG3-WC-P	17D0650-81	Drinking Water	04/14/17 12:26	04/13/17 22:00	04/14/17 16:45

8100 N. Austin Avenue Morton Grove, IL 60053-3203 P 847.967.6666 800.246.0663 F 847.967.6735 www.emt.com

BRG3-WC-F	17D0650-82	Drinking Water	04/14/17 12:26	04/13/17 22:00	04/14/17 16:45
157-DF-P	17D0650-83	Drinking Water	04/14/17 12:32	04/13/17 22:00	04/14/17 16:45
157-DF-F	17D0650-84	Drinking Water	04/14/17 12:32	04/13/17 22:00	04/14/17 16:45
157-SK-P	17D0650-85	Drinking Water	04/14/17 12:33	04/13/17 22:00	04/14/17 16:45
156-DF-P	17D0650-86	Drinking Water	04/14/17 12:34	04/13/17 22:00	04/14/17 16:45
156-DF-F	17D0650-87	Drinking Water	04/14/17 12:34	04/13/17 22:00	04/14/17 16:45
156-SK-P	17D0650-88	Drinking Water	04/14/17 12:35	04/13/17 22:00	04/14/17 16:45
155-DF-P	17D0650-89	Drinking Water	04/14/17 12:38	04/13/17 22:00	04/14/17 16:45
155-DF-F	17D0650-90	Drinking Water	04/14/17 12:38	04/13/17 22:00	04/14/17 16:45
155-SK-P	17D0650-91	Drinking Water	04/14/17 12:39	04/13/17 22:00	04/14/17 16:45
154-DF-P	17D0650-92	Drinking Water	04/14/17 12:41	04/13/17 22:00	04/14/17 16:45
154-DF-F	17D0650-93	Drinking Water	04/14/17 12:41	04/13/17 22:00	04/14/17 16:45
154-SK-P	17D0650-94	Drinking Water	04/14/17 12:42	04/13/17 22:00	04/14/17 16:45
150-SK-F	17D0650-95	Drinking Water	04/14/17 12:46	04/13/17 22:00	04/14/17 16:45
150-SK-P	17D0650-96	Drinking Water	04/14/17 12:46	04/13/17 22:00	04/14/17 16:45
151-DF-P	17D0650-97	Drinking Water	04/14/17 12:47	04/13/17 22:00	04/14/17 16:45
151-DF-F	17D0650-98	Drinking Water	04/14/17 12:47	04/13/17 22:00	04/14/17 16:45
151-SK-P	17D0650-99	Drinking Water	04/14/17 12:48	04/13/17 22:00	04/14/17 16:45
153-DF-P	17D0650-AA	Drinking Water	04/14/17 12:50	04/13/17 22:00	04/14/17 16:45
153-DF-F	17D0650-AB	Drinking Water	04/14/17 12:50	04/13/17 22:00	04/14/17 16:45
153-SK-P	17D0650-AC	Drinking Water	04/14/17 12:51	04/13/17 22:00	04/14/17 16:45
152-DF-P	17D0650-AD	Drinking Water	04/14/17 12:53	04/13/17 22:00	04/14/17 16:45
152-DF-F	17D0650-AE	Drinking Water	04/14/17 12:53	04/13/17 22:00	04/14/17 16:45
152-SK-P	17D0650-AF	Drinking Water	04/14/17 12:54	04/13/17 22:00	04/14/17 16:45

Narrative

Sample results only relate to the to the sample received at the laboratory and analytes of interest tested.

Work Order: 17D0650

The samples were received on 04/14/17 16:45. The samples arrived in good condition and properly preserved. The temperature of the cooler at receipt was

<u>Cooler</u>	<u>Temp C°</u>
Default Cooler	22.4

Refer to Qualifiers and Definitions for quality and analytical clarifications or deviations.

Client Sample Results

Client: Ramboll Environ
Project: Drinking Water Analysis
 21-42941A Lions Park
Work Order: 17D0650

Report Date: 04/21/2017

Analyses	EMT Reporting			Units	Date/Time Analyzed	Batch	Analyst
	Result	Limit	Qual				
Client Sample ID: 177-SK-P Collection Date: 4/14/2017 10:26:00A Collection Volume: 250 ml bottle	Last Time Used: 4/13/2017 10:00:00PI				Matrix: Drinking Water Lab ID: 17D0650-01		
Metals by ICP-MS							
Method: E200.8							
Lead	2.53	2.00		ppb	04/19/17 18:05	B7D0682	MLB
Client Sample ID: 177-SK-F Collection Date: 4/14/2017 10:26:00A Collection Volume: 250 ml bottle	Last Time Used: 4/13/2017 10:00:00PI				Matrix: Drinking Water Lab ID: 17D0650-02		
Metals by ICP-MS							
Method: E200.8							
Lead	< 2.00	2.00	U	ppb	04/19/17 18:06	B7D0682	MLB
Client Sample ID: 179-SK-P Collection Date: 4/14/2017 10:30:00A Collection Volume: 250 ml bottle	Last Time Used: 4/13/2017 10:00:00PI				Matrix: Drinking Water Lab ID: 17D0650-03		
Metals by ICP-MS							
Method: E200.8							
Lead	4.00	2.00		ppb	04/19/17 18:10	B7D0682	MLB
Client Sample ID: 179-SK-F Collection Date: 4/14/2017 10:30:00A Collection Volume: 250 ml bottle	Last Time Used: 4/13/2017 10:00:00PI				Matrix: Drinking Water Lab ID: 17D0650-04		
Metals by ICP-MS							
Method: E200.8							
Lead	< 2.00	2.00	U	ppb	04/19/17 18:11	B7D0682	MLB
Client Sample ID: 180-SK-P Collection Date: 4/14/2017 10:38:00A Collection Volume: 250 ml bottle	Last Time Used: 4/13/2017 10:00:00PI				Matrix: Drinking Water Lab ID: 17D0650-05		
Metals by ICP-MS							
Method: E200.8							
Lead	3.32	2.00		ppb	04/19/17 18:12	B7D0682	MLB
Client Sample ID: 180-SK-F Collection Date: 4/14/2017 10:38:00A Collection Volume: 250 ml bottle	Last Time Used: 4/13/2017 10:00:00PI				Matrix: Drinking Water Lab ID: 17D0650-06		
Metals by ICP-MS							
Method: E200.8							
Lead	< 2.00	2.00	U	ppb	04/19/17 18:14	B7D0682	MLB

Client Sample Results

(Continued)

Client: Ramboll Environ
Project: Drinking Water Analysis
 21-42941A Lions Park
Work Order: 17D0650

Report Date: 04/21/2017

Analyses	EMT Reporting			Units	Date/Time Analyzed	Batch	Analyst
	Result	Limit	Qual				
Client Sample ID: 110-SK1-P Collection Date: 4/14/2017 10:43:00A Collection Volume: 250 ml bottle Matrix: Drinking Water Lab ID: 17D0650-07							
Metals by ICP-MS Method: E200.8							
Lead	10.5	2.00		ppb	04/19/17 18:25	B7D0698	MLB
Client Sample ID: 110-SK1-F Collection Date: 4/14/2017 10:43:00A Collection Volume: 250 ml bottle Matrix: Drinking Water Lab ID: 17D0650-08							
Metals by ICP-MS Method: E200.8							
Lead	< 2.00	2.00	U	ppb	04/19/17 18:26	B7D0698	MLB
Client Sample ID: 110-SK2-P Collection Date: 4/14/2017 10:44:00A Collection Volume: 250 ml bottle Matrix: Drinking Water Lab ID: 17D0650-09							
Metals by ICP-MS Method: E200.8							
Lead	3.53	2.00		ppb	04/19/17 20:41	B7D0680	MLB
Client Sample ID: 102-SK-P Collection Date: 4/14/2017 10:48:00A Collection Volume: 250 ml bottle Matrix: Drinking Water Lab ID: 17D0650-10							
Metals by ICP-MS Method: E200.8							
Lead	2.83	2.00		ppb	04/19/17 18:28	B7D0698	MLB
Client Sample ID: 102-SK-F Collection Date: 4/14/2017 10:48:00A Collection Volume: 250 ml bottle Matrix: Drinking Water Lab ID: 17D0650-11							
Metals by ICP-MS Method: E200.8							
Lead	< 2.00	2.00	U	ppb	04/19/17 18:29	B7D0698	MLB
Client Sample ID: 111-SK1-P Collection Date: 4/14/2017 10:51:00A Collection Volume: 250 ml bottle Matrix: Drinking Water Lab ID: 17D0650-12							
Metals by ICP-MS Method: E200.8							
Lead	2.85	2.00		ppb	04/19/17 18:30	B7D0698	MLB

8100 N. Austin Avenue Morton Grove, IL 60053-3203 P 847.967.6666 800.246.0663 F 847.967.6735 www.emt.com

Client Sample Results

(Continued)

Client: Ramboll Environ
Project: Drinking Water Analysis
 21-42941A Lions Park
Work Order: 17D0650

Report Date: 04/21/2017

Analyses	EMT Reporting				Date/Time Analyzed	Batch	Analyst
	Result	Limit	Qual	Units			
Client Sample ID: 111-SK1-F Collection Date: 4/14/2017 10:51:00A Collection Volume: 250 ml bottle Matrix: Drinking Water Lab ID: 17D0650-13				Last Time Used: 4/13/2017 10:00:00PI			
Metals by ICP-MS							
Method: E200.8							
Lead	< 2.00	2.00	U	ppb	04/19/17 18:31	B7D0698	MLB
Client Sample ID: 111-SK2-P Collection Date: 4/14/2017 10:52:00A Collection Volume: 250 ml bottle Matrix: Drinking Water Lab ID: 17D0650-14				Last Time Used: 4/13/2017 10:00:00PI			
Metals by ICP-MS							
Method: E200.8							
Lead	< 2.00	2.00	U	ppb	04/19/17 18:32	B7D0698	MLB
Client Sample ID: 137-SK1-P Collection Date: 4/14/2017 10:59:00A Collection Volume: 250 ml bottle Matrix: Drinking Water Lab ID: 17D0650-15				Last Time Used: 4/13/2017 10:00:00PI			
Metals by ICP-MS							
Method: E200.8							
Lead	4.07	2.00		ppb	04/19/17 18:34	B7D0698	MLB
Client Sample ID: 137-SK1-F Collection Date: 4/14/2017 10:59:00A Collection Volume: 250 ml bottle Matrix: Drinking Water Lab ID: 17D0650-16				Last Time Used: 4/13/2017 10:00:00PI			
Metals by ICP-MS							
Method: E200.8							
Lead	< 2.00	2.00	U	ppb	04/19/17 18:35	B7D0698	MLB
Client Sample ID: 137-SK2-P Collection Date: 4/14/2017 11:00:00A Collection Volume: 250 ml bottle Matrix: Drinking Water Lab ID: 17D0650-17				Last Time Used: 4/13/2017 10:00:00PI			
Metals by ICP-MS							
Method: E200.8							
Lead	17.2	2.00		ppb	04/19/17 20:43	B7D0680	MLB
Client Sample ID: 130-DF-P Collection Date: 4/14/2017 11:02:00A Collection Volume: 250 ml bottle Matrix: Drinking Water Lab ID: 17D0650-18				Last Time Used: 4/13/2017 10:00:00PI			
Metals by ICP-MS							
Method: E200.8							
Lead	< 2.00	2.00	U	ppb	04/19/17 18:36	B7D0698	MLB

8100 N. Austin Avenue Morton Grove, IL 60053-3203 P 847.967.6666 800.246.0663 F 847.967.6735 www.emt.com

Client Sample Results

(Continued)

Client: Ramboll Environ
Project: Drinking Water Analysis
 21-42941A Lions Park
Work Order: 17D0650

Report Date: 04/21/2017

Analyses	EMT Reporting				Date/Time Analyzed	Batch	Analyst
	Result	Limit	Qual	Units			
Client Sample ID: 130-DF-F Collection Date: 4/14/2017 11:02:00A Collection Volume: 250 ml bottle	Last Time Used: 4/13/2017 10:00:00PI				Matrix: Drinking Water Lab ID: 17D0650-19		
Metals by ICP-MS							
Method: E200.8							
Lead	< 2.00	2.00	U	ppb	04/19/17 18:40	B7D0698	MLB
Client Sample ID: 130-SK-P Collection Date: 4/14/2017 11:03:00A Collection Volume: 250 ml bottle	Last Time Used: 4/13/2017 10:00:00PI				Matrix: Drinking Water Lab ID: 17D0650-20		
Metals by ICP-MS							
Method: E200.8							
Lead	32.6	2.00		ppb	04/19/17 18:41	B7D0698	MLB
Client Sample ID: 113-DF-P Collection Date: 4/14/2017 11:05:00A Collection Volume: 250 ml bottle	Last Time Used: 4/13/2017 10:00:00PI				Matrix: Drinking Water Lab ID: 17D0650-21		
Metals by ICP-MS							
Method: E200.8							
Lead	5.91	2.00		ppb	04/19/17 18:42	B7D0698	MLB
Client Sample ID: 113-DF-F Collection Date: 4/14/2017 11:05:00A Collection Volume: 250 ml bottle	Last Time Used: 4/13/2017 10:00:00PI				Matrix: Drinking Water Lab ID: 17D0650-22		
Metals by ICP-MS							
Method: E200.8							
Lead	< 2.00	2.00	U	ppb	04/19/17 18:44	B7D0698	MLB
Client Sample ID: 113-SK-P Collection Date: 4/14/2017 11:06:00A Collection Volume: 250 ml bottle	Last Time Used: 4/13/2017 10:00:00PI				Matrix: Drinking Water Lab ID: 17D0650-23		
Metals by ICP-MS							
Method: E200.8							
Lead	< 2.00	2.00	U	ppb	04/19/17 18:45	B7D0698	MLB
Client Sample ID: 129-DF-P Collection Date: 4/14/2017 11:09:00A Collection Volume: 250 ml bottle	Last Time Used: 4/13/2017 10:00:00PI				Matrix: Drinking Water Lab ID: 17D0650-24		
Metals by ICP-MS							
Method: E200.8							
Lead	< 2.00	2.00	U	ppb	04/19/17 18:46	B7D0698	MLB

Client Sample Results

(Continued)

Client: Ramboll Environ
Project: Drinking Water Analysis
 21-42941A Lions Park
Work Order: 17D0650

Report Date: 04/21/2017

Analyses	EMT Reporting				Date/Time Analyzed	Batch	Analyst
	Result	Limit	Qual	Units			
Client Sample ID: 129-DF-F Collection Date: 4/14/2017 11:09:00A Collection Volume: 250 ml bottle	Last Time Used: 4/13/2017 10:00:00PI				Matrix: Drinking Water Lab ID: 17D0650-25		
Metals by ICP-MS							
Method: E200.8							
Lead	< 2.00	2.00	U	ppb	04/19/17 18:47	B7D0698	MLB
Client Sample ID: 129-SK-P Collection Date: 4/14/2017 11:10:00A Collection Volume: 250 ml bottle	Last Time Used: 4/13/2017 10:00:00PI				Matrix: Drinking Water Lab ID: 17D0650-26		
Metals by ICP-MS							
Method: E200.8							
Lead	2.09	2.00		ppb	04/19/17 18:49	B7D0698	MLB
Client Sample ID: 114-DF-P Collection Date: 4/14/2017 11:13:00A Collection Volume: 250 ml bottle	Last Time Used: 4/13/2017 10:00:00PI				Matrix: Drinking Water Lab ID: 17D0650-27		
Metals by ICP-MS							
Method: E200.8							
Lead	< 2.00	2.00	U	ppb	04/19/17 18:50	B7D0698	MLB
Client Sample ID: 114-DF-F Collection Date: 4/14/2017 11:13:00A Collection Volume: 250 ml bottle	Last Time Used: 4/13/2017 10:00:00PI				Matrix: Drinking Water Lab ID: 17D0650-28		
Metals by ICP-MS							
Method: E200.8							
Lead	< 2.00	2.00	U	ppb	04/19/17 18:51	B7D0698	MLB
Client Sample ID: 114-SK-P Collection Date: 4/14/2017 11:14:00A Collection Volume: 250 ml bottle	Last Time Used: 4/13/2017 10:00:00PI				Matrix: Drinking Water Lab ID: 17D0650-29		
Metals by ICP-MS							
Method: E200.8							
Lead	< 2.00	2.00	U	ppb	04/19/17 19:03	B7D0699	MLB
Client Sample ID: 115-DF-P Collection Date: 4/14/2017 11:19:00A Collection Volume: 250 ml bottle	Last Time Used: 4/13/2017 10:00:00PI				Matrix: Drinking Water Lab ID: 17D0650-30		
Metals by ICP-MS							
Method: E200.8							
Lead	< 2.00	2.00	U	ppb	04/19/17 19:04	B7D0699	MLB

Client Sample Results

(Continued)

Client: Ramboll Environ
Project: Drinking Water Analysis
 21-42941A Lions Park
Work Order: 17D0650

Report Date: 04/21/2017

Analyses	EMT Reporting			Units	Date/Time Analyzed	Batch	Analyst
	Result	Limit	Qual				
Client Sample ID: 115-DF-F Collection Date: 4/14/2017 11:19:00A Collection Volume: 250 ml bottle Matrix: Drinking Water Lab ID: 17D0650-31							
Metals by ICP-MS Method: E200.8							
Lead	< 2.00	2.00	U	ppb	04/19/17 19:05	B7D0699	MLB
Client Sample ID: 115-SK-P Collection Date: 4/14/2017 11:20:00A Collection Volume: 250 ml bottle Matrix: Drinking Water Lab ID: 17D0650-32							
Metals by ICP-MS Method: E200.8							
Lead	5.60	2.00		ppb	04/19/17 19:06	B7D0699	MLB
Client Sample ID: 128-SK1-P Collection Date: 4/14/2017 11:23:00A Collection Volume: 250 ml bottle Matrix: Drinking Water Lab ID: 17D0650-33							
Metals by ICP-MS Method: E200.8							
Lead	< 2.00	2.00	U	ppb	04/19/17 19:10	B7D0699	MLB
Client Sample ID: 128-SK1-F Collection Date: 4/14/2017 11:23:00A Collection Volume: 250 ml bottle Matrix: Drinking Water Lab ID: 17D0650-34							
Metals by ICP-MS Method: E200.8							
Lead	< 2.00	2.00	U	ppb	04/19/17 19:11	B7D0699	MLB
Client Sample ID: 128-SK2-P Collection Date: 4/14/2017 11:24:00A Collection Volume: 250 ml bottle Matrix: Drinking Water Lab ID: 17D0650-35							
Metals by ICP-MS Method: E200.8							
Lead	< 2.00	2.00	U	ppb	04/19/17 19:13	B7D0699	MLB
Client Sample ID: 128-SK3-P Collection Date: 4/14/2017 11:24:00A Collection Volume: 250 ml bottle Matrix: Drinking Water Lab ID: 17D0650-36							
Metals by ICP-MS Method: E200.8							
Lead	< 2.00	2.00	U	ppb	04/19/17 19:14	B7D0699	MLB

8100 N. Austin Avenue Morton Grove, IL 60053-3203 P 847.967.6666 800.246.0663 F 847.967.6735 www.emt.com

Client Sample Results

(Continued)

Client: Ramboll Environ
Project: Drinking Water Analysis
 21-42941A Lions Park
Work Order: 17D0650

Report Date: 04/21/2017

Analyses	EMT Reporting			Units	Date/Time Analyzed	Batch	Analyst
	Result	Limit	Qual				
Client Sample ID: 128-SK4-P					Matrix: Drinking Water		
Collection Date: 4/14/2017 11:24:00A				Last Time Used: 4/13/2017 10:00:00PI	Lab ID: 17D0650-37		
Collection Volume: 250 ml bottle							
Metals by ICP-MS							
Method: E200.8							
Lead	< 2.00	2.00	U	ppb	04/19/17 19:15	B7D0699	MLB
Client Sample ID: 116-DF-P					Matrix: Drinking Water		
Collection Date: 4/14/2017 11:30:00A				Last Time Used: 4/13/2017 10:00:00PI	Lab ID: 17D0650-38		
Collection Volume: 250 ml bottle							
Metals by ICP-MS							
Method: E200.8							
Lead	< 2.00	2.00	U	ppb	04/19/17 19:16	B7D0699	MLB
Client Sample ID: 116-DF-F					Matrix: Drinking Water		
Collection Date: 4/14/2017 11:30:00A				Last Time Used: 4/13/2017 10:00:00PI	Lab ID: 17D0650-39		
Collection Volume: 250 ml bottle							
Metals by ICP-MS							
Method: E200.8							
Lead	< 2.00	2.00	U	ppb	04/19/17 19:17	B7D0699	MLB
Client Sample ID: 116-SK-P					Matrix: Drinking Water		
Collection Date: 4/14/2017 11:31:00A				Last Time Used: 4/13/2017 10:00:00PI	Lab ID: 17D0650-40		
Collection Volume: 250 ml bottle							
Metals by ICP-MS							
Method: E200.8							
Lead	3.25	2.00		ppb	04/19/17 19:19	B7D0699	MLB
Client Sample ID: BRG1-WC-P					Matrix: Drinking Water		
Collection Date: 4/14/2017 11:33:00A				Last Time Used: 4/13/2017 10:00:00PI	Lab ID: 17D0650-41		
Collection Volume: 250 ml bottle							
Metals by ICP-MS							
Method: E200.8							
Lead	< 2.00	2.00	U	ppb	04/19/17 19:20	B7D0699	MLB
Client Sample ID: BRG1-WC-F					Matrix: Drinking Water		
Collection Date: 4/14/2017 11:33:00A				Last Time Used: 4/13/2017 10:00:00PI	Lab ID: 17D0650-42		
Collection Volume: 250 ml bottle							
Metals by ICP-MS							
Method: E200.8							
Lead	< 2.00	2.00	U	ppb	04/19/17 19:21	B7D0699	MLB

Client Sample Results

(Continued)

Client: Ramboll Environ
Project: Drinking Water Analysis
 21-42941A Lions Park
Work Order: 17D0650

Report Date: 04/21/2017

Analyses	EMT Reporting			Units	Date/Time Analyzed	Batch	Analyst
	Result	Limit	Qual				
Client Sample ID: BRB1-WC-P Collection Date: 4/14/2017 11:34:00A Collection Volume: 250 ml bottle Matrix: Drinking Water Lab ID: 17D0650-43							
Metals by ICP-MS Method: E200.8							
Lead	< 2.00	2.00	U	ppb	04/19/17 19:25	B7D0699	MLB
Client Sample ID: BRB1-WC-F Collection Date: 4/14/2017 11:34:00A Collection Volume: 250 ml bottle Matrix: Drinking Water Lab ID: 17D0650-44							
Metals by ICP-MS Method: E200.8							
Lead	< 2.00	2.00	U	ppb	04/19/17 19:26	B7D0699	MLB
Client Sample ID: 117-DF-P Collection Date: 4/14/2017 11:37:00A Collection Volume: 250 ml bottle Matrix: Drinking Water Lab ID: 17D0650-45							
Metals by ICP-MS Method: E200.8							
Lead	< 2.00	2.00	U	ppb	04/19/17 19:28	B7D0699	MLB
Client Sample ID: 117-DF-F Collection Date: 4/14/2017 11:37:00A Collection Volume: 250 ml bottle Matrix: Drinking Water Lab ID: 17D0650-46							
Metals by ICP-MS Method: E200.8							
Lead	< 2.00	2.00	U	ppb	04/19/17 19:29	B7D0699	MLB
Client Sample ID: 117-SK-P Collection Date: 4/14/2017 11:38:00A Collection Volume: 250 ml bottle Matrix: Drinking Water Lab ID: 17D0650-47							
Metals by ICP-MS Method: E200.8							
Lead	2.09	2.00		ppb	04/19/17 19:30	B7D0699	MLB
Client Sample ID: 118-SK-P Collection Date: 4/14/2017 11:41:00A Collection Volume: 250 ml bottle Matrix: Drinking Water Lab ID: 17D0650-48							
Metals by ICP-MS Method: E200.8							
Lead	3.73	2.00		ppb	04/19/17 19:31	B7D0699	MLB

Client Sample Results

(Continued)

Client: Ramboll Environ
Project: Drinking Water Analysis
 21-42941A Lions Park
Work Order: 17D0650

Report Date: 04/21/2017

Analyses	EMT Reporting				Date/Time Analyzed	Batch	Analyst
	Result	Limit	Qual	Units			
Client Sample ID: 118-SK-F					Matrix: Drinking Water		
Collection Date: 4/14/2017 11:41:00A	Last Time Used: 4/13/2017 10:00:00PI				Lab ID: 17D0650-49		
Collection Volume: 250 ml bottle							
Metals by ICP-MS							
Method: E200.8							
Lead	< 2.00	2.00	U	ppb	04/20/17 13:04	B7D0743	AG
Client Sample ID: 119-DF-P					Matrix: Drinking Water		
Collection Date: 4/14/2017 11:46:00A	Last Time Used: 4/13/2017 10:00:00PI				Lab ID: 17D0650-50		
Collection Volume: 250 ml bottle							
Metals by ICP-MS							
Method: E200.8							
Lead	< 2.00	2.00	U	ppb	04/20/17 13:06	B7D0743	AG
Client Sample ID: 119-DF-F					Matrix: Drinking Water		
Collection Date: 4/14/2017 11:46:00A	Last Time Used: 4/13/2017 10:00:00PI				Lab ID: 17D0650-51		
Collection Volume: 250 ml bottle							
Metals by ICP-MS							
Method: E200.8							
Lead	< 2.00	2.00	U	ppb	04/20/17 13:07	B7D0743	AG
Client Sample ID: 119-SK-P					Matrix: Drinking Water		
Collection Date: 4/14/2017 11:47:00A	Last Time Used: 4/13/2017 10:00:00PI				Lab ID: 17D0650-52		
Collection Volume: 250 ml bottle							
Metals by ICP-MS							
Method: E200.8							
Lead	2.20	2.00		ppb	04/20/17 13:08	B7D0743	AG
Client Sample ID: 120-DF-P					Matrix: Drinking Water		
Collection Date: 4/14/2017 11:49:00A	Last Time Used: 4/13/2017 10:00:00PI				Lab ID: 17D0650-53		
Collection Volume: 250 ml bottle							
Metals by ICP-MS							
Method: E200.8							
Lead	20.5	2.00		ppb	04/20/17 13:09	B7D0743	AG
Client Sample ID: 120-DF-F					Matrix: Drinking Water		
Collection Date: 4/14/2017 11:49:00A	Last Time Used: 4/13/2017 10:00:00PI				Lab ID: 17D0650-54		
Collection Volume: 250 ml bottle							
Metals by ICP-MS							
Method: E200.8							
Lead	2.83	2.00		ppb	04/20/17 13:11	B7D0743	AG

Client Sample Results

(Continued)

Client: Ramboll Environ
Project: Drinking Water Analysis
 21-42941A Lions Park
Work Order: 17D0650

Report Date: 04/21/2017

Analyses	EMT Reporting				Date/Time Analyzed	Batch	Analyst
	Result	Limit	Qual	Units			
Client Sample ID: 120-SK-P Collection Date: 4/14/2017 11:50:00A Collection Volume: 250 ml bottle	Last Time Used: 4/13/2017 10:00:00PI				Matrix: Drinking Water Lab ID: 17D0650-55		
Metals by ICP-MS							
Method: E200.8							
Lead	22.6	2.00		ppb	04/20/17 13:12	B7D0743	AG
Client Sample ID: 124-DF-P Collection Date: 4/14/2017 11:53:00A Collection Volume: 250 ml bottle	Last Time Used: 4/13/2017 10:00:00PI				Matrix: Drinking Water Lab ID: 17D0650-56		
Metals by ICP-MS							
Method: E200.8							
Lead	< 2.00	2.00	U	ppb	04/20/17 13:13	B7D0743	AG
Client Sample ID: 124-DF-F Collection Date: 4/14/2017 11:53:00A Collection Volume: 250 ml bottle	Last Time Used: 4/13/2017 10:00:00PI				Matrix: Drinking Water Lab ID: 17D0650-57		
Metals by ICP-MS							
Method: E200.8							
Lead	< 2.00	2.00	U	ppb	04/20/17 13:17	B7D0743	AG
Client Sample ID: 124-SK-P Collection Date: 4/14/2017 11:54:00A Collection Volume: 250 ml bottle	Last Time Used: 4/13/2017 10:00:00PI				Matrix: Drinking Water Lab ID: 17D0650-58		
Metals by ICP-MS							
Method: E200.8							
Lead	< 2.00	2.00	U	ppb	04/20/17 13:18	B7D0743	AG
Client Sample ID: 123-DF-P Collection Date: 4/14/2017 11:56:00A Collection Volume: 250 ml bottle	Last Time Used: 4/13/2017 10:00:00PI				Matrix: Drinking Water Lab ID: 17D0650-59		
Metals by ICP-MS							
Method: E200.8							
Lead	< 2.00	2.00	U	ppb	04/20/17 13:19	B7D0743	AG
Client Sample ID: 123-DF-F Collection Date: 4/14/2017 11:56:00A Collection Volume: 250 ml bottle	Last Time Used: 4/13/2017 10:00:00PI				Matrix: Drinking Water Lab ID: 17D0650-60		
Metals by ICP-MS							
Method: E200.8							
Lead	< 2.00	2.00	U	ppb	04/20/17 13:21	B7D0743	AG

Client Sample Results

(Continued)

Client: Ramboll Environ
Project: Drinking Water Analysis
 21-42941A Lions Park
Work Order: 17D0650

Report Date: 04/21/2017

Analyses	EMT Reporting			Units	Date/Time Analyzed	Batch	Analyst
	Result	Limit	Qual				
Client Sample ID: 123-SK-P Collection Date: 4/14/2017 11:57:00AM Collection Volume: 250 ml bottle	Last Time Used: 4/13/2017 10:00:00PI				Matrix: Drinking Water Lab ID: 17D0650-61		
Metals by ICP-MS							
Method: E200.8							
Lead	< 2.00	2.00	U	ppb	04/20/17 13:22	B7D0743	AG
Client Sample ID: 121-DF-P Collection Date: 4/14/2017 12:00:00PI Collection Volume: 250 ml bottle	Last Time Used: 4/13/2017 10:00:00PI				Matrix: Drinking Water Lab ID: 17D0650-62		
Metals by ICP-MS							
Method: E200.8							
Lead	< 2.00	2.00	U	ppb	04/20/17 13:23	B7D0743	AG
Client Sample ID: 121-DF-F Collection Date: 4/14/2017 12:00:00PI Collection Volume: 250 ml bottle	Last Time Used: 4/13/2017 10:00:00PI				Matrix: Drinking Water Lab ID: 17D0650-63		
Metals by ICP-MS							
Method: E200.8							
Lead	< 2.00	2.00	U	ppb	04/20/17 13:24	B7D0743	AG
Client Sample ID: 121-SK-P Collection Date: 4/14/2017 12:01:00PI Collection Volume: 250 ml bottle	Last Time Used: 4/13/2017 10:00:00PI				Matrix: Drinking Water Lab ID: 17D0650-64		
Metals by ICP-MS							
Method: E200.8							
Lead	< 2.00	2.00	U	ppb	04/20/17 13:25	B7D0743	AG
Client Sample ID: 122-DF-P Collection Date: 4/14/2017 12:04:00PI Collection Volume: 250 ml bottle	Last Time Used: 4/13/2017 10:00:00PI				Matrix: Drinking Water Lab ID: 17D0650-65		
Metals by ICP-MS							
Method: E200.8							
Lead	5.83	2.00		ppb	04/20/17 13:27	B7D0743	AG
Client Sample ID: 122-DF-F Collection Date: 4/14/2017 12:04:00PI Collection Volume: 250 ml bottle	Last Time Used: 4/13/2017 10:00:00PI				Matrix: Drinking Water Lab ID: 17D0650-66		
Metals by ICP-MS							
Method: E200.8							
Lead	4.28	2.00		ppb	04/20/17 13:28	B7D0743	AG

Client Sample Results

(Continued)

Client: Ramboll Environ
Project: Drinking Water Analysis
 21-42941A Lions Park
Work Order: 17D0650

Report Date: 04/21/2017

Analyses	EMT Reporting				Date/Time Analyzed	Batch	Analyst
	Result	Limit	Qual	Units			
Client Sample ID: 122-SK-P Collection Date: 4/14/2017 12:05:00PI Collection Volume: 250 ml bottle	Last Time Used: 4/13/2017 10:00:00PI				Matrix: Drinking Water Lab ID: 17D0650-67		
Metals by ICP-MS							
Method: E200.8							
Lead	6.04	2.00		ppb	04/20/17 13:33	B7D0743	AG
Client Sample ID: BRB2-WC-P Collection Date: 4/14/2017 12:07:00PI Collection Volume: 250 ml bottle	Last Time Used: 4/13/2017 10:00:00PI				Matrix: Drinking Water Lab ID: 17D0650-68		
Metals by ICP-MS							
Method: E200.8							
Lead	< 2.00	2.00	U	ppb	04/20/17 13:34	B7D0743	AG
Client Sample ID: BRB2-WC-F Collection Date: 4/14/2017 12:07:00PI Collection Volume: 250 ml bottle	Last Time Used: 4/13/2017 10:00:00PI				Matrix: Drinking Water Lab ID: 17D0650-69		
Metals by ICP-MS							
Method: E200.8							
Lead	< 2.00	2.00	U	ppb	04/20/17 13:43	B7D0744	AG
Client Sample ID: BRG2-WC-P Collection Date: 4/14/2017 12:08:00PI Collection Volume: 250 ml bottle	Last Time Used: 4/13/2017 10:00:00PI				Matrix: Drinking Water Lab ID: 17D0650-70		
Metals by ICP-MS							
Method: E200.8							
Lead	< 2.00	2.00	U	ppb	04/20/17 13:44	B7D0744	AG
Client Sample ID: BRG2-WC-F Collection Date: 4/14/2017 12:08:00PI Collection Volume: 250 ml bottle	Last Time Used: 4/13/2017 10:00:00PI				Matrix: Drinking Water Lab ID: 17D0650-71		
Metals by ICP-MS							
Method: E200.8							
Lead	< 2.00	2.00	U	ppb	04/20/17 13:49	B7D0744	AG
Client Sample ID: 164-WC1-P Collection Date: 4/14/2017 12:14:00PI Collection Volume: 250 ml bottle	Last Time Used: 4/13/2017 10:00:00PI				Matrix: Drinking Water Lab ID: 17D0650-72		
Metals by ICP-MS							
Method: E200.8							
Lead	< 2.00	2.00	U	ppb	04/20/17 13:50	B7D0744	AG

Client Sample Results

(Continued)

Client: Ramboll Environ
Project: Drinking Water Analysis
 21-42941A Lions Park
Work Order: 17D0650

Report Date: 04/21/2017

Analyses	EMT Reporting			Units	Date/Time Analyzed	Batch	Analyst
	Result	Limit	Qual				
Client Sample ID: 164-WC1-F Collection Date: 4/14/2017 12:14:00PI Collection Volume: 250 ml bottle Matrix: Drinking Water Lab ID: 17D0650-73							
Metals by ICP-MS Method: E200.8							
Lead	< 2.00	2.00	U	ppb	04/20/17 13:51	B7D0744	AG
Client Sample ID: 164-WC2-P Collection Date: 4/14/2017 12:13:00PI Collection Volume: 250 ml bottle Matrix: Drinking Water Lab ID: 17D0650-74							
Metals by ICP-MS Method: E200.8							
Lead	< 2.00	2.00	U	ppb	04/20/17 13:52	B7D0744	AG
Client Sample ID: 164-WC2-F Collection Date: 4/14/2017 12:13:00PI Collection Volume: 250 ml bottle Matrix: Drinking Water Lab ID: 17D0650-75							
Metals by ICP-MS Method: E200.8							
Lead	< 2.00	2.00	U	ppb	04/20/17 13:54	B7D0744	AG
Client Sample ID: 159-SK1-P Collection Date: 4/14/2017 12:20:00PI Collection Volume: 250 ml bottle Matrix: Drinking Water Lab ID: 17D0650-76							
Metals by ICP-MS Method: E200.8							
Lead	2.93	2.00		ppb	04/20/17 13:55	B7D0744	AG
Client Sample ID: 159-SK1-F Collection Date: 4/14/2017 12:20:00PI Collection Volume: 250 ml bottle Matrix: Drinking Water Lab ID: 17D0650-77							
Metals by ICP-MS Method: E200.8							
Lead	< 2.00	2.00	U	ppb	04/20/17 13:56	B7D0744	AG
Client Sample ID: 159-SK2-P Collection Date: 4/14/2017 12:21:00PI Collection Volume: 250 ml bottle Matrix: Drinking Water Lab ID: 17D0650-78							
Metals by ICP-MS Method: E200.8							
Lead	< 2.00	2.00	U	ppb	04/20/17 13:57	B7D0744	AG

Client Sample Results

(Continued)

Client: Ramboll Environ
Project: Drinking Water Analysis
 21-42941A Lions Park
Work Order: 17D0650

Report Date: 04/21/2017

Analyses	EMT Reporting			Units	Date/Time Analyzed	Batch	Analyst
	Result	Limit	Qual				
Client Sample ID: BRB3-WC-P Collection Date: 4/14/2017 12:25:00PI Collection Volume: 250 ml bottle Matrix: Drinking Water Lab ID: 17D0650-79							
Metals by ICP-MS Method: E200.8							
Lead	< 2.00	2.00	U	ppb	04/20/17 13:58	B7D0744	AG
Client Sample ID: BRB3-WC-F Collection Date: 4/14/2017 12:25:00PI Collection Volume: 250 ml bottle Matrix: Drinking Water Lab ID: 17D0650-80							
Metals by ICP-MS Method: E200.8							
Lead	< 2.00	2.00	U	ppb	04/20/17 14:00	B7D0744	AG
Client Sample ID: BRG3-WC-P Collection Date: 4/14/2017 12:26:00PI Collection Volume: 250 ml bottle Matrix: Drinking Water Lab ID: 17D0650-81							
Metals by ICP-MS Method: E200.8							
Lead	< 2.00	2.00	U	ppb	04/20/17 14:05	B7D0744	AG
Client Sample ID: BRG3-WC-F Collection Date: 4/14/2017 12:26:00PI Collection Volume: 250 ml bottle Matrix: Drinking Water Lab ID: 17D0650-82							
Metals by ICP-MS Method: E200.8							
Lead	< 2.00	2.00	U	ppb	04/20/17 14:06	B7D0744	AG
Client Sample ID: 157-DF-P Collection Date: 4/14/2017 12:32:00PI Collection Volume: 250 ml bottle Matrix: Drinking Water Lab ID: 17D0650-83							
Metals by ICP-MS Method: E200.8							
Lead	< 2.00	2.00	U	ppb	04/20/17 14:07	B7D0744	AG
Client Sample ID: 157-DF-F Collection Date: 4/14/2017 12:32:00PI Collection Volume: 250 ml bottle Matrix: Drinking Water Lab ID: 17D0650-84							
Metals by ICP-MS Method: E200.8							
Lead	< 2.00	2.00	U	ppb	04/20/17 14:08	B7D0744	AG

Client Sample Results

(Continued)

Client: Ramboll Environ
Project: Drinking Water Analysis
 21-42941A Lions Park
Work Order: 17D0650

Report Date: 04/21/2017

Analyses	EMT Reporting				Date/Time Analyzed	Batch	Analyst
	Result	Limit	Qual	Units			
Client Sample ID: 157-SK-P Collection Date: 4/14/2017 12:33:00PI Collection Volume: 250 ml bottle	Last Time Used: 4/13/2017 10:00:00PI				Matrix: Drinking Water Lab ID: 17D0650-85		
Metals by ICP-MS							
Method: E200.8							
Lead	< 2.00	2.00	U	ppb	04/20/17 14:10	B7D0744	AG
Client Sample ID: 156-DF-P Collection Date: 4/14/2017 12:34:00PI Collection Volume: 250 ml bottle	Last Time Used: 4/13/2017 10:00:00PI				Matrix: Drinking Water Lab ID: 17D0650-86		
Metals by ICP-MS							
Method: E200.8							
Lead	< 2.00	2.00	U	ppb	04/20/17 14:11	B7D0744	AG
Client Sample ID: 156-DF-F Collection Date: 4/14/2017 12:34:00PI Collection Volume: 250 ml bottle	Last Time Used: 4/13/2017 10:00:00PI				Matrix: Drinking Water Lab ID: 17D0650-87		
Metals by ICP-MS							
Method: E200.8							
Lead	< 2.00	2.00	U	ppb	04/20/17 14:12	B7D0744	AG
Client Sample ID: 156-SK-P Collection Date: 4/14/2017 12:35:00PI Collection Volume: 250 ml bottle	Last Time Used: 4/13/2017 10:00:00PI				Matrix: Drinking Water Lab ID: 17D0650-88		
Metals by ICP-MS							
Method: E200.8							
Lead	3.74	2.00		ppb	04/20/17 14:13	B7D0744	AG
Client Sample ID: 155-DF-P Collection Date: 4/14/2017 12:38:00PI Collection Volume: 250 ml bottle	Last Time Used: 4/13/2017 10:00:00PI				Matrix: Drinking Water Lab ID: 17D0650-89		
Metals by ICP-MS							
Method: E200.8							
Lead	< 2.00	2.00	U	ppb	04/20/17 14:25	B7D0745	AG
Client Sample ID: 155-DF-F Collection Date: 4/14/2017 12:38:00PI Collection Volume: 250 ml bottle	Last Time Used: 4/13/2017 10:00:00PI				Matrix: Drinking Water Lab ID: 17D0650-90		
Metals by ICP-MS							
Method: E200.8							
Lead	< 2.00	2.00	U	ppb	04/20/17 14:27	B7D0745	AG

Client Sample Results

(Continued)

Client: Ramboll Environ
Project: Drinking Water Analysis
 21-42941A Lions Park
Work Order: 17D0650

Report Date: 04/21/2017

Analyses	EMT Reporting				Date/Time Analyzed	Batch	Analyst
	Result	Limit	Qual	Units			
Client Sample ID: 155-SK-P Collection Date: 4/14/2017 12:39:00PI Collection Volume: 250 ml bottle	Last Time Used: 4/13/2017 10:00:00PI				Matrix: Drinking Water Lab ID: 17D0650-91		
Metals by ICP-MS							
Method: E200.8							
Lead	2.64	2.00		ppb	04/20/17 14:28	B7D0745	AG
Client Sample ID: 154-DF-P Collection Date: 4/14/2017 12:41:00PI Collection Volume: 250 ml bottle	Last Time Used: 4/13/2017 10:00:00PI				Matrix: Drinking Water Lab ID: 17D0650-92		
Metals by ICP-MS							
Method: E200.8							
Lead	< 2.00	2.00	U	ppb	04/20/17 14:29	B7D0745	AG
Client Sample ID: 154-DF-F Collection Date: 4/14/2017 12:41:00PI Collection Volume: 250 ml bottle	Last Time Used: 4/13/2017 10:00:00PI				Matrix: Drinking Water Lab ID: 17D0650-93		
Metals by ICP-MS							
Method: E200.8							
Lead	< 2.00	2.00	U	ppb	04/20/17 14:30	B7D0745	AG
Client Sample ID: 154-SK-P Collection Date: 4/14/2017 12:42:00PI Collection Volume: 250 ml bottle	Last Time Used: 4/13/2017 10:00:00PI				Matrix: Drinking Water Lab ID: 17D0650-94		
Metals by ICP-MS							
Method: E200.8							
Lead	< 2.00	2.00	U	ppb	04/20/17 14:31	B7D0745	AG
Client Sample ID: 150-SK-F Collection Date: 4/14/2017 12:46:00PI Collection Volume: 250 ml bottle	Last Time Used: 4/13/2017 10:00:00PI				Matrix: Drinking Water Lab ID: 17D0650-95		
Metals by ICP-MS							
Method: E200.8							
Lead	< 2.00	2.00	U	ppb	04/20/17 14:37	B7D0745	AG
Client Sample ID: 150-SK-P Collection Date: 4/14/2017 12:46:00PI Collection Volume: 250 ml bottle	Last Time Used: 4/13/2017 10:00:00PI				Matrix: Drinking Water Lab ID: 17D0650-96		
Metals by ICP-MS							
Method: E200.8							
Lead	2.72	2.00		ppb	04/20/17 14:38	B7D0745	AG

8100 N. Austin Avenue Morton Grove, IL 60053-3203 P 847.967.6666 800.246.0663 F 847.967.6735 www.emt.com

Client Sample Results

(Continued)

Client: Ramboll Environ
Project: Drinking Water Analysis
 21-42941A Lions Park
Work Order: 17D0650

Report Date: 04/21/2017

Analyses	EMT Reporting				Date/Time Analyzed	Batch	Analyst
	Result	Limit	Qual	Units			
Client Sample ID: 151-DF-P Collection Date: 4/14/2017 12:47:00PI Collection Volume: 250 ml bottle	Last Time Used: 4/13/2017 10:00:00PI				Matrix: Drinking Water Lab ID: 17D0650-97		
Metals by ICP-MS							
Method: E200.8							
Lead	< 2.00	2.00	U	ppb	04/20/17 14:39	B7D0745	AG
Client Sample ID: 151-DF-F Collection Date: 4/14/2017 12:47:00PI Collection Volume: 250 ml bottle	Last Time Used: 4/13/2017 10:00:00PI				Matrix: Drinking Water Lab ID: 17D0650-98		
Metals by ICP-MS							
Method: E200.8							
Lead	< 2.00	2.00	U	ppb	04/20/17 14:40	B7D0745	AG
Client Sample ID: 151-SK-P Collection Date: 4/14/2017 12:48:00PI Collection Volume: 250 ml bottle	Last Time Used: 4/13/2017 10:00:00PI				Matrix: Drinking Water Lab ID: 17D0650-99		
Metals by ICP-MS							
Method: E200.8							
Lead	3.99	2.00		ppb	04/20/17 14:42	B7D0745	AG
Client Sample ID: 153-DF-P Collection Date: 4/14/2017 12:50:00PI Collection Volume: 250 ml bottle	Last Time Used: 4/13/2017 10:00:00PI				Matrix: Drinking Water Lab ID: 17D0650-AA		
Metals by ICP-MS							
Method: E200.8							
Lead	< 2.00	2.00	U	ppb	04/20/17 14:43	B7D0745	AG
Client Sample ID: 153-DF-F Collection Date: 4/14/2017 12:50:00PI Collection Volume: 250 ml bottle	Last Time Used: 4/13/2017 10:00:00PI				Matrix: Drinking Water Lab ID: 17D0650-AB		
Metals by ICP-MS							
Method: E200.8							
Lead	< 2.00	2.00	U	ppb	04/20/17 14:44	B7D0745	AG
Client Sample ID: 153-SK-P Collection Date: 4/14/2017 12:51:00PI Collection Volume: 250 ml bottle	Last Time Used: 4/13/2017 10:00:00PI				Matrix: Drinking Water Lab ID: 17D0650-AC		
Metals by ICP-MS							
Method: E200.8							
Lead	< 2.00	2.00	U	ppb	04/20/17 14:45	B7D0745	AG

Client Sample Results

(Continued)

Client: Ramboll Environ
Project: Drinking Water Analysis
 21-42941A Lions Park
Work Order: 17D0650

Report Date: 04/21/2017

Analyses	EMT Reporting			Units	Date/Time Analyzed	Batch	Analyst
	Result	Limit	Qual				
Client Sample ID: 152-DF-P					Matrix: Drinking Water		
Collection Date: 4/14/2017 12:53:00PI				Last Time Used: 4/13/2017 10:00:00PI	Lab ID: 17D0650-AD		
Collection Volume: 250 ml bottle							
Metals by ICP-MS							
Method: E200.8							
Lead	< 2.00	2.00	U	ppb	04/20/17 14:47	B7D0745	AG
Client Sample ID: 152-DF-F					Matrix: Drinking Water		
Collection Date: 4/14/2017 12:53:00PI				Last Time Used: 4/13/2017 10:00:00PI	Lab ID: 17D0650-AE		
Collection Volume: 250 ml bottle							
Metals by ICP-MS							
Method: E200.8							
Lead	< 2.00	2.00	U	ppb	04/20/17 14:48	B7D0745	AG
Client Sample ID: 152-SK-P					Matrix: Drinking Water		
Collection Date: 4/14/2017 12:54:00PI				Last Time Used: 4/13/2017 10:00:00PI	Lab ID: 17D0650-AF		
Collection Volume: 250 ml bottle							
Metals by ICP-MS							
Method: E200.8							
Lead	3.37	2.00		ppb	04/20/17 14:53	B7D0745	AG

Qualifiers and Definitions

Item	Description
U	Analyte included in the analysis, but not detected
%Rec	Percent Recovery

Certified Analyses included in this Report

Analyte	CAS #	Certifications
E200.8 in Drinking Water		
Lead	7439-92-1	ILEPA

List of Certifications

Code	Description	Number	Expires
AKDEC	State of Alaska, Dept. Environmental Conservation	UST-105	07/16/2017
CPSC	US Consumer Product Safety Commission, Accredited by PJLA Lab No. 1050	L14-56	04/30/2018
DoD	Department of Defense, Accredited by PJLA	L14-55	04/30/2018
ILEPA	State of Illinois, NELAP Accredited Lab No. 100256	003674	07/27/2017
ISO	ISO/IEC 17025, Accredited by PJLA	L14-56	04/30/2018
LELAP	State of Louisiana, NELAP Accredited Lab No. 171344	05015	06/30/2017
NJDEP	State of New Jersey, NELAP Accredited Lab No. IL010	NLC160001	06/30/2017
WDNR	State of Wisconsin Dept of Natural Resources	999888890	08/31/2017



Environmental Monitoring and Technol
8100 Austin Ave
Morton Grove
IL, 60053-3203



17D0650
PM: Tim Witrzek
Ramboll Environ
Drinking Water Analysis

Phone: 847-324-3320
Fax: 847-967-6735

of 9
CUL Number 17D0650
Lab Work Order Number

Client Name Ramboll Environ Corp		Project Name Lead in Water Sampling		Requested Analyses				Requested Turn Around	
Client Contact Robert Livingston		Project Number		2008 - Lead				Rush requests subject to additional charge.	
Address 333 W. Wacker Dr. Ste 2700		Project Description Lions Park						Rush requests subject to lab approval.	
City Chicago		PO Number 21-42941A						7	
State/Zip IL 60606		Shipped By						Standard (days)	
Phone 312-288-3800		Fax		Tracking Number				Expedited (days)	
Sampler KIE Carson / CJ Wu		Sample Signature [Signature]						Due Date	

Sample Name or Field ID	Sampled Date	Sampled Time	Sample Type Code	Matrix Code	Container Count	Preservation Code										Sample Comments		
						3												
177-SK-P	4-14-17	1026	Grab	DW	1	1												01A
177-SK-F		1026																02A
179-SK-P		1030																03A
179-SK-F		1030																04A
180-SK-P		1038																05A
180-SK-F		1038																06A
110-SK1-P		1043																Facing sink to the left 07A
110-SK1-F		1043																08A
110-SK2-P		1044																Facing sink to the right 09A
102-SK-P		1048																10A
102-SK-F		1048																11A
101-SK-F 111-SK1-P		1051																Facing sink to the left 12A
101-SK-F 111-SK1-F		1051																13A
Relinquished By [Signature]	Date/Time 4-14-17 645	Received By				Date/Time	Sample Kit Prepared By Tim Witrzek				Date/Time							
Relinquished By	Date/Time	Received By				Date/Time	Comments Time of last water use at the facility:											
Relinquished By	Date/Time	Received By [Signature]				Date/Time 4/14/17 1645	**Analytical method used must have detection limit of 2 ppb											
Cooler Numbers and Temperatures 22.4																		

Matrix Codes:
DF = Drinking Fountain - no refrigeration
WC = Water Cooler - with refrigeration
SK = Sink
BF = Bottle Filler

DW = Drinking Water
C = Corridor

P = first draw (primary)
F = flush

Preserv. Codes: 3 = Nitric Acid < 2, Store at 4 C



Environmental Monitoring and Technologies
 8100 Austin Ave
 Morton Grove
 IL, 60053-3203

CHAIN OF CUSTODY

Page 2 of 9

Phone: 847-324-3320
 Fax: 847-967-6735

COC Number _____
 Lab Work Order Number _____

Client Name Ramboll Environ Corp		Project Name Lead in Water Sampling		Requested Analyses				Requested Turn Around	
Client Contact Robert Livingston		Project Number							
Address 333 W. Wacker Dr. Ste 2700		Project Description Lions Park		2008 - Lead				Rush requests subject to additional charge.	
City Chicago		PO Number 21-42941A						Rush requests subject to lab approval.	
State/Zip IL 60606		Shipped By						7	
Phone 312-288-3800		Tracking Number						Standard (days)	
Fax		Sampler Signature Kitt Carson / CJ Wu						Expedited (days)	
Sampler								Due Date	

Sample Name or Field ID	Sampled Date	Sampled Time	Sample Type Code	Matrix Code	Container Count	Preservation Code						Sample Comments
						3						
111-SK2-P	4-14-17	10:52	Grab	DW	1	1						Facing sink to the left 14A
139-SK1-P		10:59										Facing sink to the left 15A
139-SK1-F		10:59										Facing sink to the right 16A
139-SK2-P		11:00										17A
130-DF-P		11:02										18A
130-DF-F		11:02										19A
130-SK-P		11:03										20A
113-DF-P		11:05										21A
113-DF-F		11:05										22A
113-SK-P		11:06										23A
129-DF-P		11:09										24A
129-DF-F		11:09										25A
129-SK-P		11:10										26A
Relinquished By Kitt Carson / CJ Wu		Date/Time 4-14-17 1645	Received By			Date/Time	Sample Kit Prepared By Tim Witrzek				Date/Time	
Relinquished By		Date/Time	Received By			Date/Time	Comments					
Relinquished By		Date/Time	Received By Shubert			Date/Time 4/14/17 1645	Time of last water use at the facility:					
Cooler Numbers and Temperatures		22.4			**Analytical method used must have detection limit of 2 ppb							

Matrix Codes: DW= Drinking Water, DF = Drinking Fountain - no refrigeration, WC = Water Cooler - with refrigeration, SK = Sink, BF = Bottle Filler
 C= Corridor, P = first draw (primary), F = flush
 Preservation Codes: 3= Nitric Acid < 2, Store at 4 C



Environmental Monitoring and Technologies
 8100 Austin Ave
 Morton Grove
 IL, 60053-3203

CHAIN OF CUSTODY

Page 3 of 9

Phone: 847-324-3320
 Fax: 847-967-6735

COC Number _____
 Lab Work Order Number _____

Client Name Ramboll Environ Corp		Project Name Lead in Water Sampling		Requested Analyses								Requested Turn Around				
Client Contact Robert Livingston		Project Number		2008 - Lead											Rush requests subject to additional charge. Rush requests subject to lab approval.	
Address 333 W. Wacker Dr. Ste 2700		Project Description Lions Park			7		Standard (days)									
City Chicago		PO Number 21-42941A			Expedited (days)											
State/Zip IL 60606		Shipped By			Due Date											
Phone 312-288-3800		Tracking Number														
Fax		Sampler Signature <i>[Signature]</i>														
Sampler Kit Carson / CJ W																

Sample Name or Field ID	Sampled Date	Sampled Time	Sample Type Code	Matrix Code	Container Count	Preservation Code										Sample Comments					
						3															
114-DF-P	4-14-17	11:13	Grab	DW	1	1															
114-DF-F		11:13																			
114-SK-P		11:14																			
115-DF-P		11:19																			
115-DF-F		11:19																			
115-SK-P		11:20																			
128-SK1-P		11:23																			Facing sink to the left
128-SK1-F		11:23																			left
128-SK2-P		11:24																			middle
128-SK3-P		11:24																			middle
128-SK4-P		11:24																			right
116-DF-P		11:30																			
116-DF-F		11:30																			
Relinquished By <i>[Signature]</i>		Date/Time 4-14-17 1645	Received By			Date/Time	Sample Kit Prepared By Tim Witrzek			Date/Time											
Relinquished By		Date/Time	Received By			Date/Time	Comments Time of last water use at the facility:														
Relinquished By		Date/Time	Received By <i>[Signature]</i>			Date/Time 4/14/17 1645	**Analytical method used must have detection limit of 2 ppb														
Cooler Numbers and Temperatures 22.4																					

27A
 28A
 29A
 30A
 31A
 32A
 33A
 34A
 35A
 36A
 37A
 38A
 39A

Matrix Codes:
 DF = Drinking Fountain - no refrigeration
 WC = Water Cooler - with refrigeration
 SK = Sink
 BF = Bottle Filler

DW= Drinking Water
 C= Corridor

P = first draw (primary)
 F = flush

Preserv. Codes: 3= Nitric Acid < 2, Store at 4 C



Environmental Monitoring and Technologies
 8100 Austin Ave
 Morton Grove
 IL, 60053-3203

CHAIN OF CUSTODY

Page 4 of 9

Phone: 847-324-3320
 Fax: 847-967-6735

COC Number _____
 Lab Work Order Number _____

Client Name Ramboll Environ Corp		Project Name Lead in Water Sampling		Requested Analyses				Requested Turn Around	
Client Contact Robert Livingston		Project Number 21-42941A		2008 - Lead					Rush requests subject to additional charge. Rush requests subject to lab approval. 7 Standard (days) Expedited (days) Due Date
Address 333 W. Wacker Dr. Ste 2700		Project Description Lions Park							
City Chicago		PO Number							
State/Zip IL 60606		Shipped By							
Phone 312-288-3800		Tracking Number							
Fax		Sampler Signature <i>[Signature]</i>							
Sampler KE Carson / CJ Wu									

Sample Name or Field ID	Sampled Date	Sampled Time	Sample Type Code	Matrix Code	Container Count	Preservation Code										Sample Comments		
						3												
116-SK-P	4-14-17	11:31	Grab	DW	1	1												40A
BRG1-WC-P		11:33																41A
BRG1-WC-F		11:33																42A
BRB1-WC-P		11:34																43A
BRB1-WC-F		11:34																44A
117-DF-P		11:37																45A
117-DF-F		11:37																46A
117-SK-P		11:38																47A
118-DF-P		11:40																
118-DF-F		11:40																
118-SK-P		11:41																Please run. 48A
118-SK-F		11:41																49A
119-DF-P		11:46																50A
Relinquished By <i>[Signature]</i>	Date/Time 4-15-17	Received By <i>[Signature]</i>	Date/Time 4-14-17 1645	Sample Kit Prepared By Tim Witrzek		Date/Time		Comments Time of last water use at the facility: **Analytical method used must have detection limit of 2 ppb										
Relinquished By	Date/Time	Received By	Date/Time															
Relinquished By	Date/Time	Received By	Date/Time															
Cooler Numbers and Temperatures 22.4																		

Matrix Codes: DW= Drinking Water, C= Corridor, DF = Drinking Fountain - no refrigeration, WC = Water Cooler - with refrigeration, SK = Sink, BF = Bottle Filler

Preserv. Codes: 3= Nitric Acid < 2, Store at 4 C, P = first draw (primary), F = flush

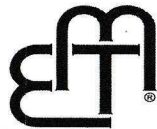

Environmental Monitoring and Technologies
 8100 Austin Ave
 Morton Grove
 IL, 60053-3203

CHAIN OF CUSTODY

Page 5 of 9

Phone: 847-324-3320
 Fax: 847-967-6735

COC Number _____
 Lab Work Order Number _____

Client Name Ramboll Environ Corp		Project Name Lead in Water Sampling		Requested Analyses					Requested Turn Around	
Client Contact Robert Livingston		Project Number 21-42941A		2008 - Lead						Rush requests subject to additional charge. Rush requests subject to lab approval. 7 Standard (days) Expedited (days) Due Date
Address 333 W. Wacker Dr. Ste 2700		Project Description Lions Park								
City Chicago		PO Number								
State/Zip IL 60606		Shipped By								
Phone 312-288-3800		Tracking Number								
Sampler Kitt Carson / CJ Wu		Sampler Signature CJ Wu								

Sample Name or Field ID	Sampled Date	Sampled Time	Sample Type Code	Matrix Code	Container Count	Preservation Code										Sample Comments	
						3											
119-DF-F	4/14/17	11:46	Grab	DW	1	1											57A
119-SK-P		11:47															52A
120-DF-P		11:49															53A
120-DF-F		11:49															54A
120-SK-P		11:50															55A
124-DF-P		11:53															56A
124-DF-F		11:53															57A
124-SK-P		11:54															58A
123-DF-P		11:56															59A
123-DF-F		11:56															60A
123-SK-P		11:57															61A
121-DF-P		12:00															62A
121-DF-F		12:00															63A
Relinquished By CJ Wu	Date/Time 4-14-17	Received By [Signature]	Date/Time 4/14/17 16:13	Sample Kit Prepared By Tim Witrzek		Date/Time		Comments Time of last water use at the facility: **Analytical method used must have detection limit of 2 ppb									
Cooler Numbers and Temperatures 22.4																	

Matrix Codes: DW= Drinking Water, C= Corridor, P = first draw (primary), F = flush
 DF = Drinking Fountain - no refrigeration
 WC = Water Cooler - with refrigeration
 SK = Sink
 BF = Bottle Filler
 Preserv. Codes: 3= Nitric Acid < 2, Store at 4 C



Environmental Monitoring and Technologies
 8100 Austin Ave
 Morton Grove
 IL, 60053-3203

CHAIN OF CUSTODY

Page 6 of 9

Phone: 847-324-3320
 Fax: 847-967-6735

COC Number _____
 Lab Work Order Number _____

Client Name Ramboll Environ Corp		Project Name Lead in Water Sampling		Requested Analyses				Requested Turn Around	
Client Contact Robert Livingston		Project Number 21-42941A		2008 - Lead					Rush requests subject to additional charge. Rush requests subject to lab approval. 7 Standard (days) Expedited (days) Due Date
Address 333 W. Wacker Dr. Ste 2700		Project Description Lions Park							
City Chicago		PO Number							
State/Zip IL 60606		Shipped By							
Phone 312-288-3800		Tracking Number							
Sampler KE Cohen / CJ Wu		Sampler Signature <i>Clayton Wu</i>							

Sample Name or Field ID	Sampled Date	Sampled Time	Sample Type Code	Matrix Code	Container Count	Preservation Code										Sample Comments		
						3												
KC 164 121-SK-P	4-14-19	1201	Grab	DW	1	1												64A
122-DF-P		1204																65A
122-DF-F		1204																66A
122-SK-P		1205																67A
BRB2-WC-P		1207																68A
BRB2-WC-F		1207																69A
BRB BRG2-WC-P		1208																70A
BRG2-WC-F		1208																71A
KC 164-DF1-P 164-WC1-P		12:14																closer to hallway 72A
KC 164-DF1 164-WC1-F		12:14																73A
KC 164-DF2-P 164-WC2-P		12:13																Further from hallway 74A
KC 164-DF2 164-WC2-F		12:13																Further from hallway 75A
159-SK1-P		1220																Facing sink to the right 76A
Relinquished By <i>Clayton Wu</i>	Date/Time 4-15-19 1645	Received By		Date/Time	Sample Kit Prepared By Tim Witrzek		Date/Time											
Relinquished By	Date/Time	Received By		Date/Time	Comments		Time of last water use at the facility:											
Relinquished By	Date/Time	Received By <i>Robert Livingston</i>		Date/Time 4/14/19 1645	**Analytical method used must have detection limit of 2 ppb													
Cooler Numbers and Temperatures		22.4																

Matrix Codes: DW= Drinking Water, DF = Drinking Fountain - no refrigeration, WC = Water Cooler - with refrigeration, SK = Sink, BF = Bottle Filler, C= Corridor, P = first draw (primary), F = flush
 Preserv. Codes: 3= Nitric Acid < 2, Store at 4 C



Environmental Monitoring and Technologies
 8100 Austin Ave
 Morton Grove
 IL, 60053-3203

CHAIN OF CUSTODY

Page 7 of 9

Phone: 847-324-3320
 Fax: 847-967-6735

COC Number _____
 Lab Work Order Number _____

Client Name Ramboll Environ Corp		Project Name Lead in Water Sampling		Requested Analyses								Requested Turn Around	
Client Contact Robert Livingston		Project Number 21-42941A		2008 - Lead								Rush requests subject to additional charge.	
Address 333 W. Wacker Dr. Ste 2700		Project Description Lions Park										Rush requests subject to lab approval.	
City Chicago		PO Number										7	
State/Zip IL 60606		Shipped By										Standard (days)	
Phone 312-288-3800		Tracking Number										Expedited (days)	
Fax		Sampler Signature <i>[Signature]</i>										Due Date	
Sampler K. Carson, CJW													

Sample Name or Field ID	Sampled Date	Sampled Time	Sample Type Code	Matrix Code	Container Count	Preservation Code										Sample Comments		
						3												
159-SK1-F	4/14/17	1220	Grab	DW	1	1												Facing sink to the right
159-SK2-P		1221																← left
BRB3-WC-P		1225																
BRB3-WC-F		1225																80A
BRG3-WC-P		1226																81A
BRG3-WC-F		1226																82A
157-DF-P		12:32																83A
157-DF-F		12:32																84A
157-SK-P		12:33																85A
156-DF-P		1234																86A
156-DF-F		1234																87A
156-SK-P		1235																88A
155-DF-P		1238																89A
Relinquished By <i>[Signature]</i>	Date/Time 4-14-17 1645	Received By			Date/Time	Sample Kit Prepared By Tim Witrzek			Date/Time									
Relinquished By	Date/Time	Received By			Date/Time	Comments Time of last water use at the facility:												
Relinquished By	Date/Time	Received By <i>[Signature]</i>			Date/Time 4/14/17 1645	**Analytical method used must have detection limit of 2 ppb												
Cooler Numbers and Temperatures 22.4																		

Matrix Codes:
 DW= Drinking Water
 DF = Drinking Fountain – no refrigeration
 WC = Water Cooler – with refrigeration
 SK = Sink
 BF = Bottle Filler

C= Corridor
 P = first draw (primary)
 F = flush

Preserv. Codes: 3= Nitric Acid < 2, Store at 4 C

77A
 78A
 79A



Environmental Monitoring and Technologies
 8100 Austin Ave
 Morton Grove
 IL, 60053-3203

CHAIN OF CUSTODY

Page 8 of 9

Phone: 847-324-3320
 Fax: 847-967-6735

COC Number _____
 Lab Work Order Number _____

Client Name Ramboll Environ Corp		Project Name Lead in Water Sampling		Requested Analyses				Requested Turn Around	
Client Contact Robert Livingston		Project Number 21-42941A		2008 - Lead					Rush requests subject to additional charge.
Address 333 W. Wacker Dr. Ste 2700		Project Description Lions Park							Rush requests subject to lab approval.
City Chicago		PO Number							7
State/Zip IL 60606		Shipped By							Standard (days)
Phone 312-288-3800		Tracking Number							Expedited (days)
Fax		Sampler Signature <i>[Signature]</i>						Due Date	

Sample Name or Field ID	Sampled Date	Sampled Time	Sample Type Code	Matrix Code	Container Count	Preservation Code										Sample Comments		
						3												
155-DF-F	4-14-17	12:38	Grab	DW	1	1												90A
155-SK-P		12:39																91A
154-DF-P		12:41																92A
154-DF-F		12:41																93A
154-SK-P		12:42																faucet leaking ~ 40 drops/min 94A
150-DF-P		12:45																
150-DF-F		12:46																95A
150-SK-P		12:46																Faucet leaking ~ 25 drops/min 96A
151-DF-P		12:47																97A
151-DF-F		12:47																98A
151-SK-P		12:48																99A
153-DF-P		12:50																100A AA A
153-DF-F		12:50																101A AB A
Relinquished By <i>[Signature]</i>		Date/Time 4-14-17 1645	Received By		Date/Time	Sample Kit Prepared By Tim Witrzek		Date/Time										
Relinquished By		Date/Time	Received By		Date/Time	Comments												
Relinquished By		Date/Time	Received By <i>[Signature]</i>		Date/Time 4/17/17 1645	Time of last water use at the facility:												
Cooler Numbers and Temperatures		22.4				**Analytical method used must have detection limit of 2 ppb												

Matrix Codes:
 DW= Drinking Water
 DF = Drinking Fountain – no refrigeration
 WC = Water Cooler – with refrigeration
 SK = Sink
 BF = Bottle Filler

C= Corridor

P = first draw (primary)
 F = flush

Preserv. Codes: 3= Nitric Acid < 2, Store at 4 C



Environmental Monitoring and Technologies
 8100 Austin Ave
 Morton Grove
 IL, 60053-3203

CHAIN OF CUSTODY

Page 9 of 9

Phone: 847-324-3320
 Fax: 847-967-6735

COC Number _____
 Lab Work Order Number _____

Client Name Ramboll Environ Corp		Project Name Lead in Water Sampling		Requested Analyses				Requested Turn Around	
Client Contact Robert Livingston		Project Number 21-42941A		2008 - Lead					Rush requests subject to additional charge.
Address 333 W. Wacker Dr. Ste 2700		Project Description Lions Park							Rush requests subject to lab approval.
City Chicago		PO Number							7
State/Zip IL 60606		Shipped By							Standard (days)
Phone 312-288-3800		Fax		Tracking Number					Expedited (days)
Sample K. Carson, CJW		Sampler Signature <i>[Signature]</i>							Due Date

Sample Name or Field ID	Sampled Date	Sampled Time	Sample Type Code	Matrix Code	Container Count	3	Preservation Code				Sample Comments
153-SK-P	4-14-17	12:51	Grab	DW	1	1					Sink faucet 1 packig = 15 drops per min. ADA
152-DF-P		1253									AE A
152-DF-F		1253									AE A
152-SK-P		1254									AFA
<div style="display: flex; justify-content: space-around;"> <div style="text-align: center;"> <p>4/14/17</p> <p>WC</p> </div> <div style="text-align: center;"> <p>4/14/17</p> <p>WC</p> </div> </div>											
Relinquished By <i>[Signature]</i>		Date/Time 4-14-17 1645		Received By <i>[Signature]</i>		Date/Time 4/14/17 1645		Sample Kit Prepared By Tim Witrzek		Date/Time	
Relinquished By		Date/Time		Received By		Date/Time		Comments		Time of last water use at the facility:	
Relinquished By		Date/Time		Received By <i>[Signature]</i>		Date/Time 4/14/17 1645		***Analytical method used must have detection limit of 2 ppb			
Cooler Numbers and Temperatures 22.4											

Matrix Codes: DW= Drinking Water, DF = Drinking Fountain - no refrigeration, WC = Water Cooler - with refrigeration, SK = Sink, BF = Bottle Filler, C= Corridor

Preserv. Codes: 3= Nitric Acid < 2, Store at 4 C

P = first draw (primary), F = flush

ADA
 AEA
 per min.



17D0650

 PM: Tim Witrzek
 Ramboll Environ
 Drinking Water Analysis

Sample Receipt Checklist

Work Order: 17D0650

Printed: 4/17/2017 9:10:09AM

Client: Ramboll Environ Project: Drinking Water Analysis	Date Due: 04/21/17 17:00 (5 day TAT)
---	---

Received By: Boi Trinh Logged In By: Sarah Akinde		Date Received: 04/14/17 16:45 Date Logged In: 04/17/17 08:16
--	--	---

Samples Received at:	22.4°C
How were samples received?	Client
Custody Seals Present	No
Custody Seals Intact	NA
Sample Cont/Cooler Intact	Yes
COC Present/Complete	Yes
COC/Labels Agree	No
Proper Cont/Preservation	Yes
Sufficient Sample Volume	Yes
Samples Within Holdtime	Yes
Cooler Temp Within Limits	Yes
VOA Water Vials Received	No
VOA Water Vials/Zero Headspace	NA
PM or Client Contacted	No

COMMENTS

The coc has 157-SK-P collection date/time 4/14/17 at 12:33. The container received is labeled as 157-DF-P collected 4/14/17 at 12:33. Container is labeled as on coc.

The coc has 159-SK1-P date and time collected is 4/14/17 at 12:20 and the container received is labeled as 159-SK-P collected on 4/14/17 at 12:20. Container is labeled as on the coc. SA1

**Mount Prospect School District 57
Lions Park Elementary School**

**APPENDIX B
FLOOR PLANS**

NO ENTRANCE
STAFF PARKING

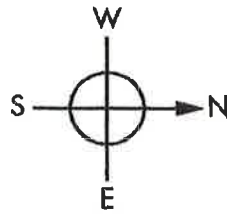

BUS TURNAROUND
NO DROP OFF/ PICK UP BY CARS

NO STOPPING/PARKING - DROP OFF/PICKUP ONLY

COUNCIL TRAIL

only SK-P
DF done work c 118

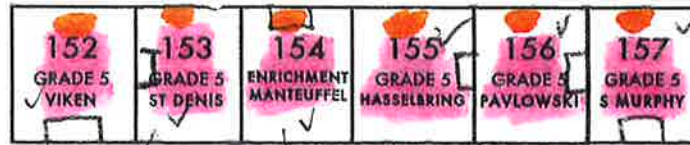

DOOR #9 Sink faucet leaking 15 drops/min
DOOR #10 Sink leaking = 40 drops/min BRBWC

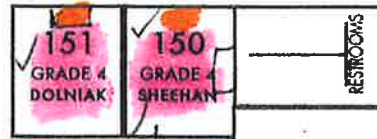

SK only DF did network
sink faucet leaking ~25 drops/min

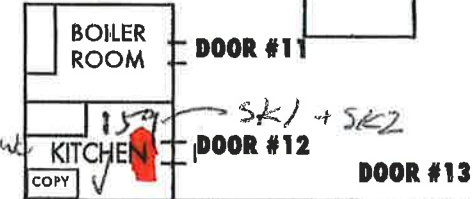

BRG3-wc SK1 + SK2

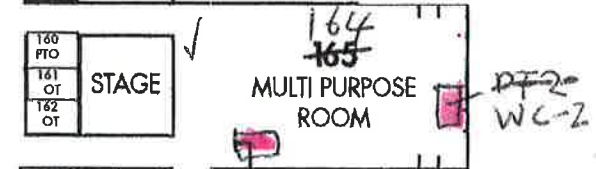

DF2 WC-2

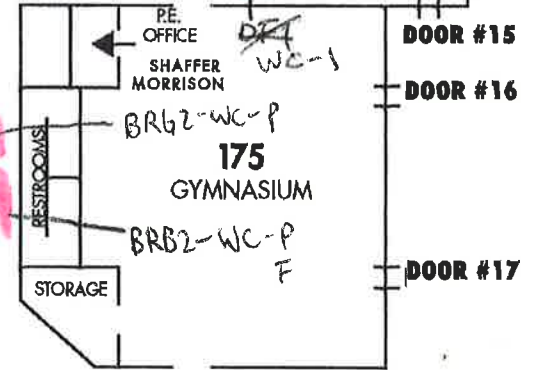

BRB2-WC-P
BRB2-WC-P F

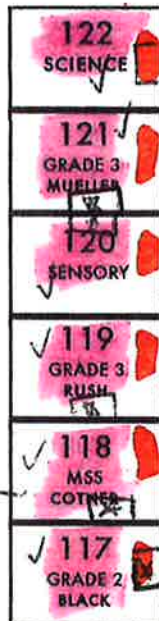

DOOR #3



4 faucets in one sink

SK1 = P
SK2 = P
SK3 = P
SK4 = P
DOOR #6

DOOR #4

DOOR #5



DOOR #7

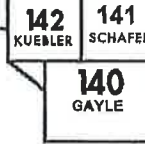

DOOR #8

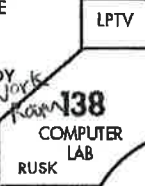

BRB1-WC-P
BRG1-WC-P

Bathroom (not sampled)

Two fixtures - primaries and 1-flush

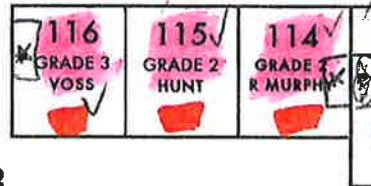

DOOR #2

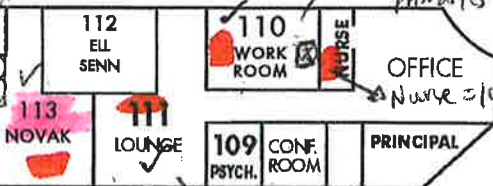

DOOR #1

Two fixtures - primaries one flush



DOOR #20 DOOR #19

Bathroom not sampled regardless

Water Main

Drinking Fountains - 30
Sinks - 31

SCHOOL STREET
NO STOPPING/PARKING - DROP OFF/PICKUP ONLY

SCHOOL MAP 2016-2017

30 Drinking Fountains * water last used before 10pm 4/15/2019
51 Sinks